



**\*\*AVAILABLE JULY 2026\*\* \*\*FURNISHED\*\***

An inviting two bedroom ground floor 'Tyneside' flat ideally located on Grosvenor Road, Jesmond. Fully furnished and in a great location the property is only a short walk from a selection of bars, restaurants, shops and transport links!

The accommodation briefly comprises entrance lobby through to entrance hall, there is a master double bedroom to the front, with bay window and wood flooring. The second bedroom, central to the property with under-stairs storage cupboard is currently being used as a study but could also be used as a second double bedroom if preferred. There is a lounge, spacious in size with storage cupboard and a feature fireplace. The kitchen is traditional in style, with tiled flooring and appliances including a gas oven & hob, washing machine and fridge freezer. To the rear of the flat there is a family bathroom, with tiled flooring and a three piece suite comprising bath with shower over, WC and wash hand basin. Externally there is a shared yard to the rear with a garage door allowing access for one car to be parked. There is also on street permit parking to the front.

Available 25th July 2026 | £1,000pcm | Furnished  
| Ground Floor 'Tyneside' Flat | 679 Sq. ft (63.0 m<sup>2</sup>) | Fantastic Location | Master Double Bedroom | Second Double Bedroom/ Study | Lounge | Fitted Kitchen | Bathroom WC | Shared Rear Yard | Permit Parking | GCH & DG | Council Tax Band: B | EPC Rating: D

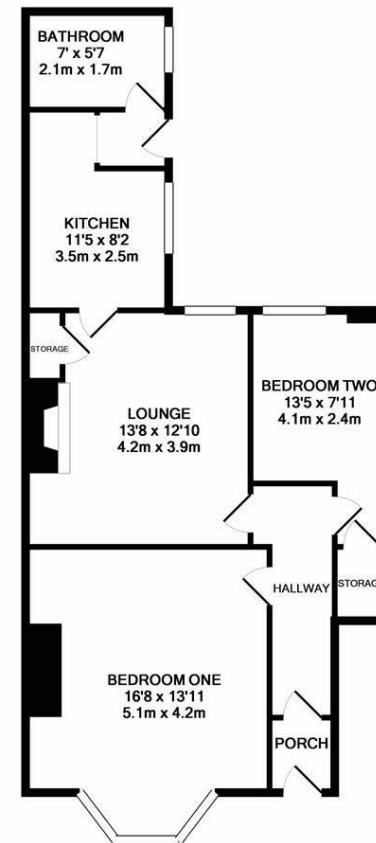

TOTAL APPROX. FLOOR AREA 679 SQ.FT. (63.0 SQ.M.)

Whilst every attempt has been made to ensure the accuracy of the floor plan contained here, measurements of doors, windows, rooms and any other items are approximate and no responsibility is taken for any error, omission, or mis-statement. This plan is for illustrative purposes only and should be used as such by any prospective purchaser. The services, systems and appliances shown have not been tested and no guarantee as to their operability or efficiency can be given.  
Made with Metropix ©2017

**£1,000 PCM**

**IMPORTANT NOTE:** These particulars and the descriptions and measurements herein do not constitute representation and whilst every effort has been made to ensure accuracy, this cannot be guaranteed.

